

# HAZ METAL FIXING SYSTEMS

Your Fixing Systems Specialist



## Stone Fixings

Product Brochure  
HAZ-BR-SF-EN/12.14

# Stone Fixing Systems - Bolt Anchors

Fixing systems need to accommodate all types of backing walls whether they are concrete walls, block work & masonry walls or steel structures.

The following points are taken into consideration when designing a fixing system for natural stone installation.

- Stone type and dimensions.
- Cavity structure: projection size and insulation.
- Application type: horizontal or vertical joint installation.
- Joint size.
- Structural wall backing.
- Height of facade.
- Relevant dynamic loads such as wind and seismic loads.
- Design criteria of the project.

HAZ Metal proposes and specially designs fixing systems according to individual projects requirements.

There are a wide range of standard anchors that can be picked for the project requirements.

## HZ Z Anchor Fixing System

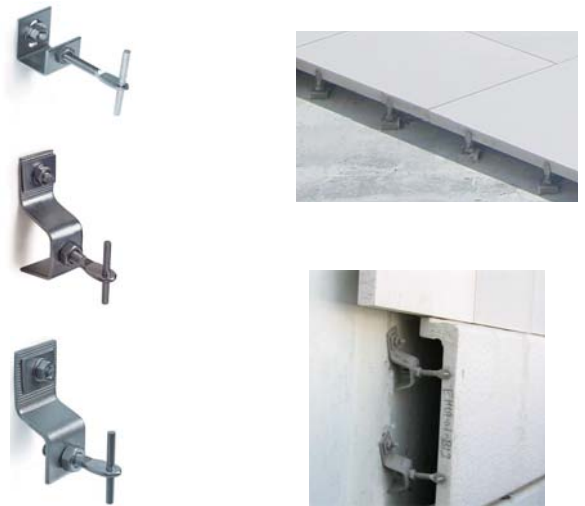

## Direct fixing to concrete at horizontal joints

Fixing to concrete with anchors using expansion bolts. When installing at horizontal joints each anchor bears half the load of the stone panels.

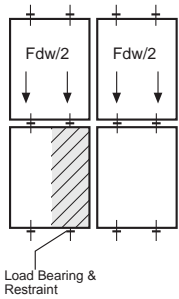

## AXO Body Anchor Fixing



## Direct fixing to concrete at vertical joints

Fixing to concrete with bolt anchors using expansion bolts. Insulation is cut at each anchoring point. When installing at vertical joints each anchor bears full load of the stone panels.

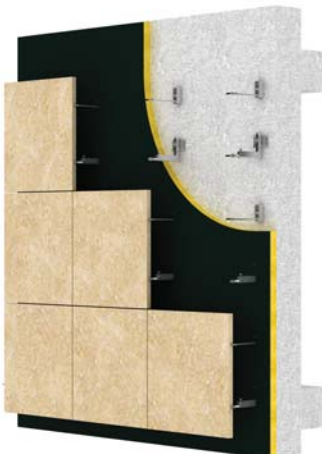
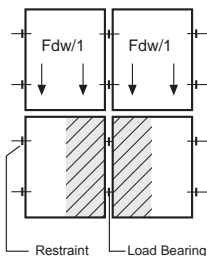

## HA L Anchor Fixing System



### HZ02-S Z Anchor



Product code	Projection (Kmm)	Dead Load (FdwN)	Wind pressure	Windsuction (FwsN)	Forming size (Fmm)
HZ02-S-33020/10	50	500	312	219	20
HZ02-S-33040/10	75	500	312	219	40
HZ02-S-33060/10	95	400	312	219	60
HZ02-S-33080/10	125	300	312	219	80
HZ02-S-43040/12	90	600	312	219	40
HZ02-S-43060/12	110	500	312	219	60
HZ02-S-43080/12	130	400	312	219	80
HZ02-S-430100/12	150	400	312	219	100
HZ02-S-430120/12	170	300	312	219	120
HZ02-S-53560/14	110	600	312	219	60
HZ02-S-53580/14	130	600	312	219	80
HZ02-S-535100/14	150	400	312	219	100
HZ02-S-535120/14	170	400	312	219	120

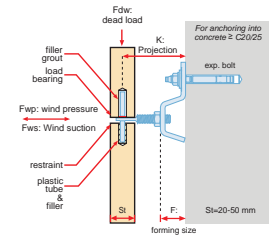

### BA Body Anchor



Product code	Projection (Kmm)	Dead Load (FdwN)	Wind pres. (Fwp N)	Windsuction (FwsN)	Forming size (Fmm)
BA-609	60	900	1,100	770	28
BA-858	85	800	700	700	46
BA-1207	120	700	650	650	75
BA-1607	160	700	600	600	115

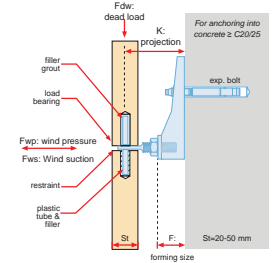

### AXO Body Anchors



Product code	Projection (Kmm)	Dead Load (FdwN)	Wind pressure	Windsuction (FwsN)	Forming size (Fmm)
AXO4-1805	180	500	780	546	135
AXO4-2005	200	500	780	546	155
AXO4-2205	220	500	780	546	175
AXO4-2405	240	500	780	546	195
AXO4-2605	260	500	780	546	215
AXO4-1809	180	500	1430	1000	135
AXO4-2009	200	900	1430	1000	155
AXO4-2209	220	900	1430	1000	175
AXO4-2409	240	900	1430	1000	195
AXO4-2609	260	900	1430	1000	215
AXO4-18013	180	1300	2028	1419	135
AXO4-20013	200	1300	2028	1419	155
AXO4-22013	220	1300	2028	1419	175
AXO4-24013	240	1300	2028	1419	195
AXO4-26013	260	1300	2028	1419	215

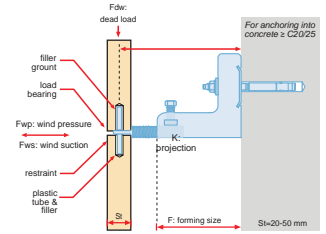

### HA01-S L Anchor



Product code	Projection (Kmm)	Dead Load (FdwN)	Wind pressure	Windsuction (FwsN)	Forming size (Fmm)
HA01-302	30	200	312	219	36
HA01-352	35	200	312	219	41
HA01-402	40	200	312	219	46
HA01-452	45	200	312	219	51
HA01-502	50	200	312	219	56
HA01-552	55	200	312	219	61
HA01-304	30	400	624	437	38
HA01-354	35	400	624	437	43
HA01-404	40	400	624	437	48
HA01-454	45	400	624	437	53
HA01-504	50	400	624	437	58
HA01-554	55	400	624	437	63

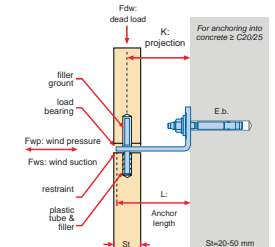

### HA04-S L Anchors



Product code	Projection (Kmm)	Dead Load (FdwN)	Wind pressure	Windsuction (FwsN)	Forming size (Fmm)
HA04-606	60	600	936	655	50
HA04-806	80	600	936	546	60
HA04-1006	100	600	936	546	70
HA04-1206	120	600	936	546	90
HA04-1406	140	600	936	546	110
HA04-1606	160	600	936	546	130
HA04-1806	180	600	936	546	150
HA04-1008	60	800	1235	865	50
HA04-1208	80	800	1235	865	60
HA04-1008	100	800	1235	865	70
HA04-1208	120	800	1235	865	90
HA04-1408	140	800	1235	865	110
HA04-1608	160	800	1235	865	130
HA04-1808	180	800	1235	865	150

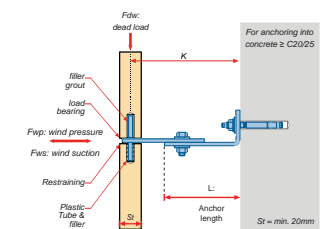

- Material: Stainless Steel 1.4301 (A2) & 1.4401 (A4).
- Loads stated are working resistance loads.
- Other sizes are available for production upon request.
- Bolts are provided separately.
- Structural calculation reports are available upon order.
- Please check Stone Fixings Product Technical Catalog for further information

### HZ Z Anchors



- Fixing to concrete with anchor bolts
- Projection sizes up to 135 mm
- Recommended for loads up to 800N
- Installation at horizontal or vertical joints
- Three dimensional adjustability

### AXO Body Anchors

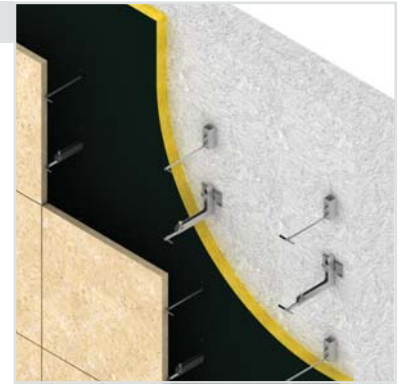

- Fixing to concrete with anchor bolts
- Projection sizes up to 260 mm
- Recommended for loads up to 1300 N
- Installation at horizontal or vertical joints
- Optimum static performance
- Three dimensional adjustability

### HA L Anchors

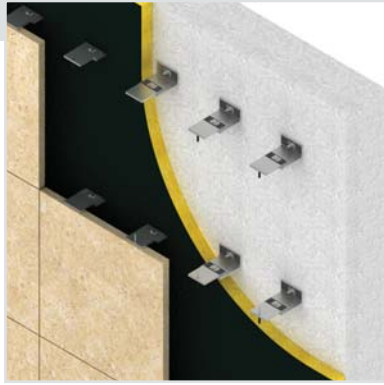

- Fixing to concrete with anchor bolts
- Can be used for stone thickness's higher than 50 mm
- Various types to enable adjustability
- Installation at horizontal joints only

### HDM Mortar Anchors



- Fixing to masonry with mortar
- Projection sizes up to 240 mm
- Recommended for loads up to 1200 N
- Installation at horizontal or vertical joints
- Three dimensional adjustability



Demir Bank, Istanbul



Adnoc HQ, Abu Dhabi



Usadba Centre, Moscow



chborn Plaza, Frankfurt