

HAZ METAL FIXING SYSTEMS

Your Fixing Systems Specialist

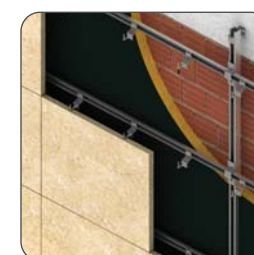
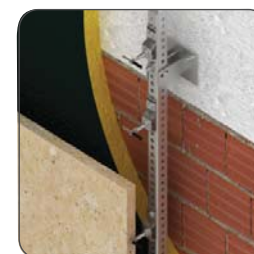

Sub Channel Systems

Product Brochure
HAZ-BR-SB-EN/12.14

Sub Channel Systems - Steel Channels

HMP Sub channel systems are used for stone cladding on to non-load bearing walls or on to walls structures where there are high projection sizes. By using specially designed channel support and restraints, channels are spanned between floor levels, creating a sub frame on to which installation is enabled by using set screws and nuts.

- Channels are fixed on to channel supports that are fastened to load bearing beams, spanning between floor levels overlaying in front of the thermal insulation
- Stone fixing is done with anchors that are fixed on to channels either with set screws or lock nut sets
- High load bearing capacity to fit projection sizes up to 360 mm
- Greater projection sizes are achieved with special design
- Fully adjustable and allows quick and easy installation
- Lower drilling points increases production rate and reduces cold bridging

Sub Channel Fixing System with Vertically spanned channels



Sub Channel Fixing System with Vertically & Horizontally spanned channels

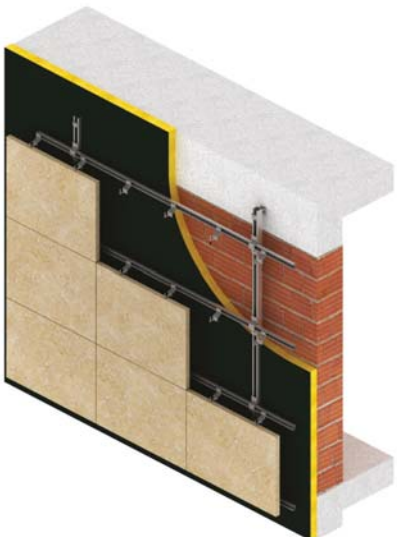

HMPC-HC1 Sub Channel Fixing System

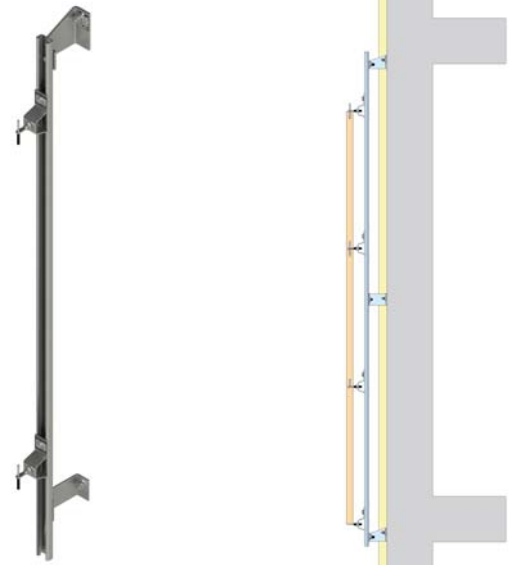

HMPA-HC2 Sub Channel Fixing System

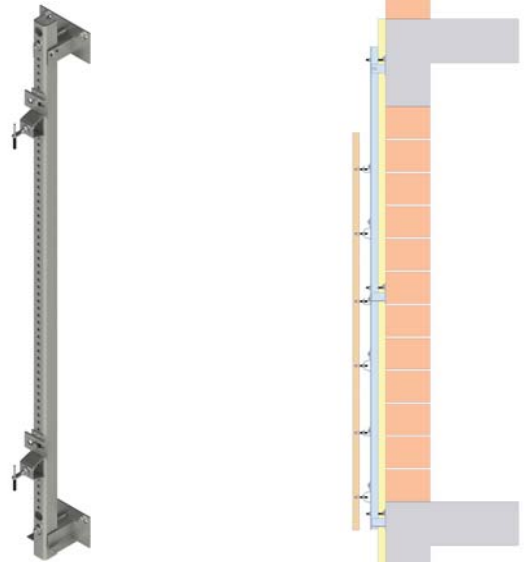

HMPC-HC1/H Sub Channel Fixing System

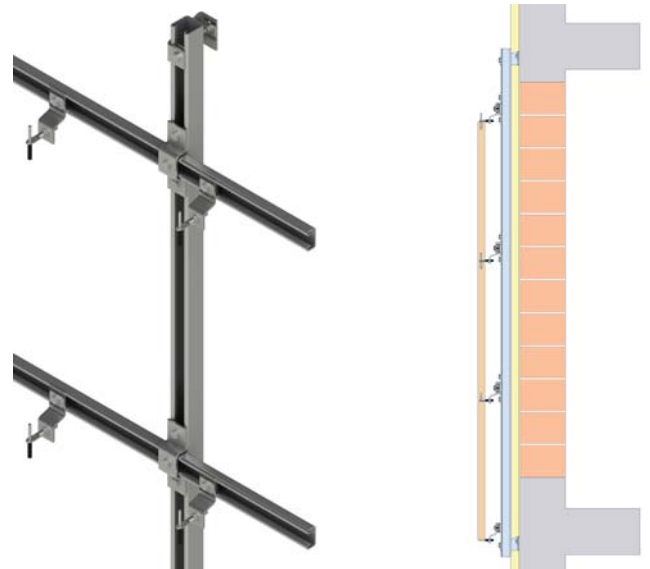

Sub channel systems manufactured out of cold rolled steel and stainless steel. Various type of systems can be formulated with the availability of different types of channel supports and restraints. Steel channel systems are preferred for high load stone facade installations. Available in Stainless steel and hot dip galvanized mild steel.

Sub Channel System

HMPA-HC2

HMPA-HC3

HMPC-HC1

ATS

HMPC-HC1/H

HMPA-HC1/H

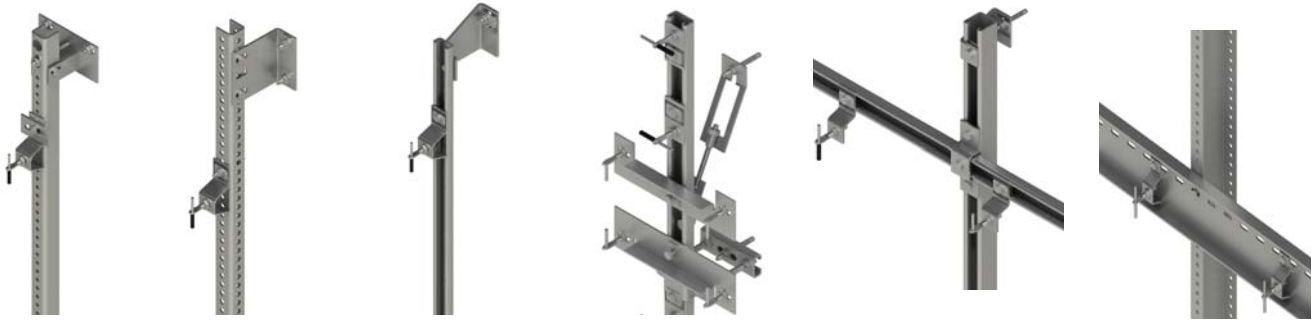

Steel Channels

HMPA U Channel

HMPL L Channel

HMPB C Channel

HMPC C Channel

HMPS Toothed channel



Channel Supports

HCSP1

HCSP2

HCSP3

HCSP4

HCSP5

ATS-S



Channel restraints

HCRS1

HCRS2

HCRS3

HCRS4

HCRS5

ATS-R



Adjustable Anchors

HZ02 Z Anchor

HRS1 Restraint Anchor

HZ00 Z Anchor

HZ01 Z Anchor

HCC-J Connection



HMPA-HC2
Sub Channel System



- Projection sizes up to 350 mm
- Ideal for heavy loads and large projections
- Installation in vertical and horizontal joints
- Adjustability in all directions, +/-30 mm
- Fixing to channels with set screw sets

HMP-ATS
Sub Channel System



- Projection sizes up to 360 mm
- Ideal for varying projection sizes and stone panel dimensions
- Adjustability in all directions
- Fixing to channels with lock nut sets

HMPC-HC1/H
Sub Channel System



- Projection sizes up to 300 mm
- Ideal for staggered patterned facades
- Quick adjustability at horizontal axis
- Installation at horizontal joints
- Fixing to channels with lock nut sets

HMPA-HC3
Sub Channel System

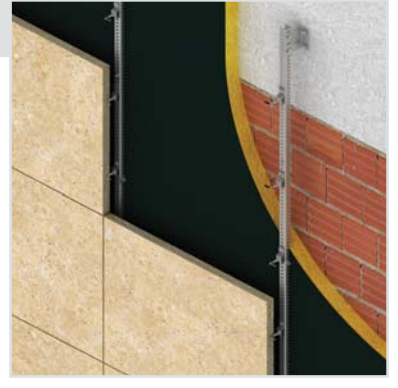

- Projection sizes up to 250 mm
- Fast & easy, and economic
- Installation at horizontal and vertical joints
- Fixing to channels with set screw sets



Four Seasons Hotel, Cairo



Is Bankasi HQ, Istanbul



Texas College, Qatar